

## CASE STUDY

### MediTrac<sup>®</sup> CMT New Main Lines for Medical Center Expansion

- Saves Time
- Saves Money
- Increases Installation Options

**Product:** MediTrac<sup>®</sup> CMT Medical Gas Piping System

**Location:** Healthcare Facility, Greensboro, NC.

**Contractor:** McKenney's



Cone Healthcare facility,  
Greensboro, NC.

#### Project Overview

A facility undergoing expansion and renovation needed to provide mainlines to the new wing. The tie in points for the Oxygen, Vacuum and Medical air were located on the first floor of the original building and the routing required a floor change up to the second floor and running out to the connection point for the new wing. Built prior to 1980 and having undergone numerous changes over the past 40 + years, the ceiling spaces were very crowded. MediTrac personnel had the opportunity to walk the site with the PM, director of facilities and design engineer. The conclusion reached by all involved was that the benefits MediTrac brought to the job were ideal. Minimizing hot work, the ability to conform to the shape of the building and long continuous run would make the installation smoother for the contractor and minimize the risk of hot work in an operating facility.

MediTrac personnel worked closely with all involved in the project to ensure a successful installation. Installing over 2,000 feet of pipe into an operating facility is always a challenging task, and even more so when it involves mostly 1 ½ and 2-inch pipe being pulled and pushed through crowded existing spaces. McKenney's prepared for the job by having extra couplings on site in case work had to be stopped for unexpected obstacles or events, creating extra flexibility in the installation process. The floor change was accomplished utilizing a traditional cleaned and capped copper riser which enabled easy straight connections of the MediTrac fittings into the copper risers.



2" MediTrac CMT system above  
ceiling grid.

(continued)

## CASE STUDY

### MediTrac<sup>®</sup> CMT New Main Lines for Medical Center Expansion

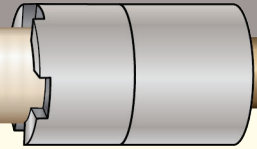

*(continued from front)*



*Four continuous runs of MediTrac CMT.*



*The start of multiple runs of 2" MediTrac piping.*



*Tie in connection.*

#### Conclusion

Utilizing MediTrac in place of traditional cleaned and capped copper eliminated the risk of brazing in the ceiling space of an operating facility. MediTrac reduced the number of fittings by over 80% as there were countless directional and elevation changes required when routing the pipe through the operating building.

#### Summary of MediTrac Materials Used

300' of 1/2" MediTrac
1,000' of 1-1/2" MediTrac
1,000' of 2" MediTrac
8 – 2" Straight Fittings
8 – 1-1/2" Straight Fittings
8 – 2" Couplings
8 – 1-1/2" Couplings
6 – 1/2" Straight Fittings